

# HollandPrice



## 12/597 - 605 SYDNEY ROAD BRUNSWICK VIC

BRAND NEW FIRST FLOOR OFFICE SUITE IN BLUE CHIP SYDNEY ROAD LOCATION. SURROUNDED BY GOOD QUALITY BRAND NAME RETAIL/COMMERCIAL TENANCY. APPROX 80 SQM AND FEATURES INCLUDE ONSITE SECURITY PARKING, LIFT ACCESS, HEATING AND COOLING, SECURITY WITH BONUS EXTERNAL GARDEN AREAS. LEASE TERMS NEGOTIABLE - TO BE LEASED SEPARATELY OR WITH SUITE 11.

**Building Size** : 80 sqm  
**View** : <https://www.hollandprice.com.au/lease/vic/north/brunswick/commercial/offices/1633424>



**Luciano Deodato**  
9384 0022

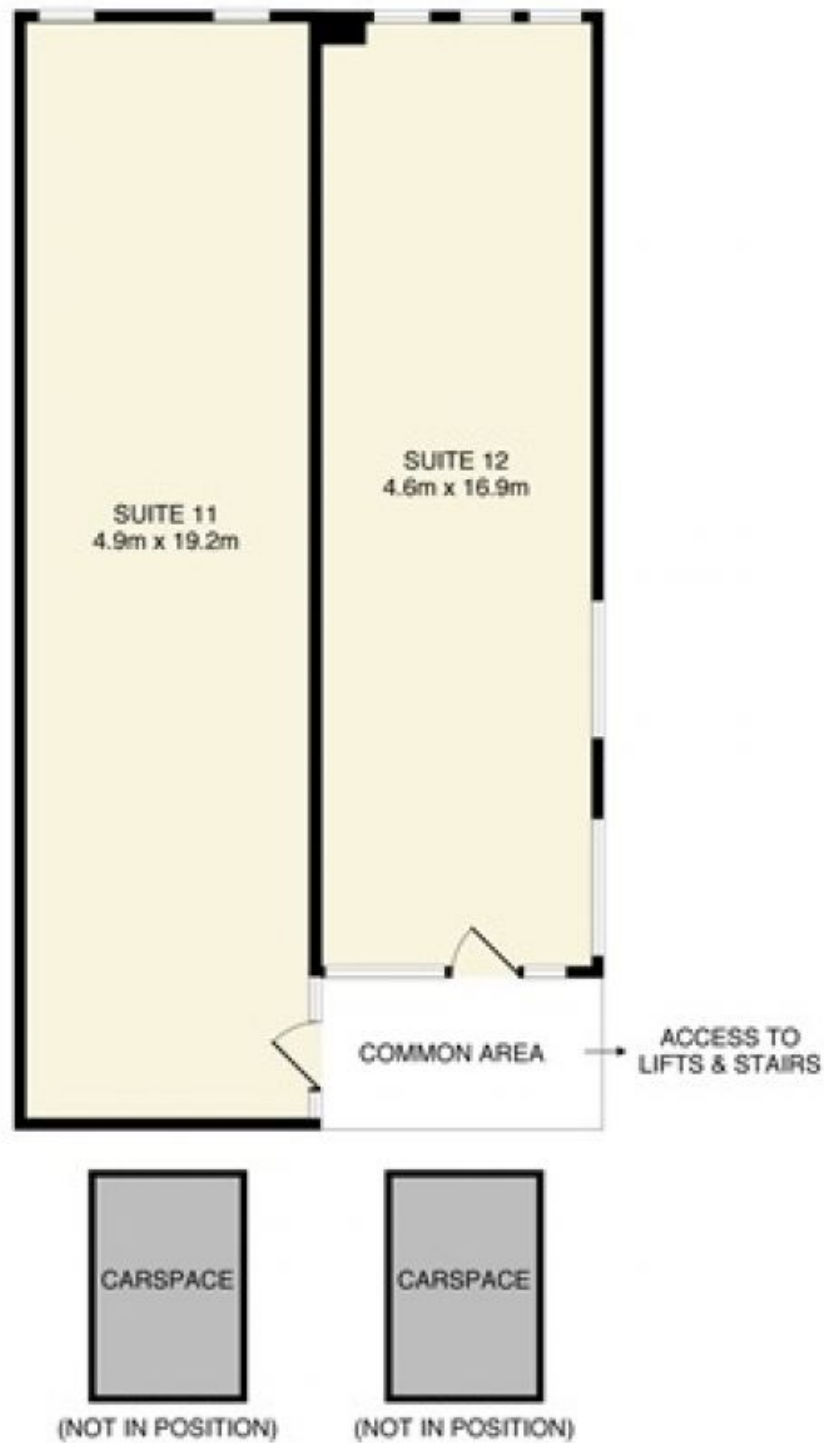

### SUITE 11 & 12, 599 - 605 SYDNEY ROAD BRUNSWICK

Whilst every attempt has been made to ensure the accuracy of the floor plan contained here, measurements of doors, windows, rooms and any other items are approximate and no responsibility is taken for any error, omission, or mis-statement. This plan is for illustrative purposes only and should be used as such by any prospective purchaser. The services, systems and appliances shown have not been tested and no guarantee as to their operability or efficiency can be given.