



36 Crana Grove GREENSBOROUGH VIC

4 2 2

Fabulously fresco focused thanks to a huge decked area with fabulous views and great for year round use, this home truly lets you live it up inside and out. Set on a corner allotment of 621m² (approx) this impressive family home offers an increasingly rare opportunity. The flexible floor plan perfectly complements the outdoor spaces, all in a family friendly location.

The lower level, opening from the double carport, under house storage, a spacious living room or even a home based business. The main living level comprises three bedrooms including main with ensuite, family bathroom, spacious living dining and kitchen with stunning views. Within easy reach of Apollo Parkways schools and shops, parks and public transport it provides family friendly living in a quiet location.

View : <https://www.hollandprice.com.au/sale/vic/north/greensborough/residential/house/3398713>



Rita Piraino
03 9384 0022



Robert Sordello
9384 0022

36 CRANA GROVE, GREENSBOROUGH



GROUND FLOOR

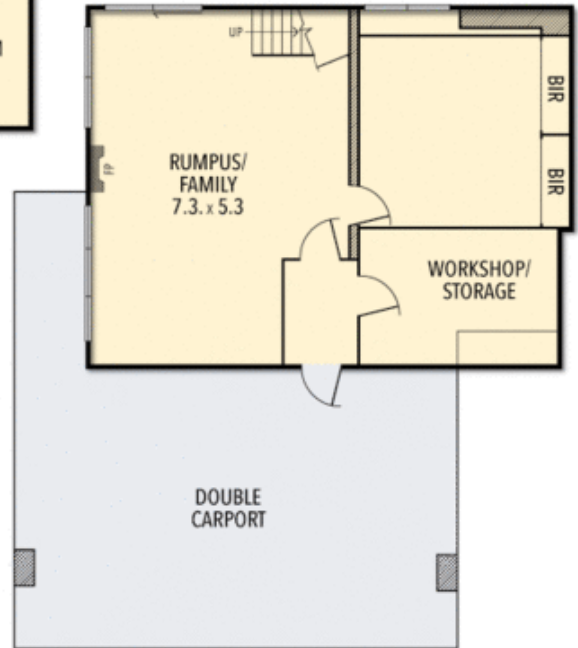

LOWER GROUND FLOOR

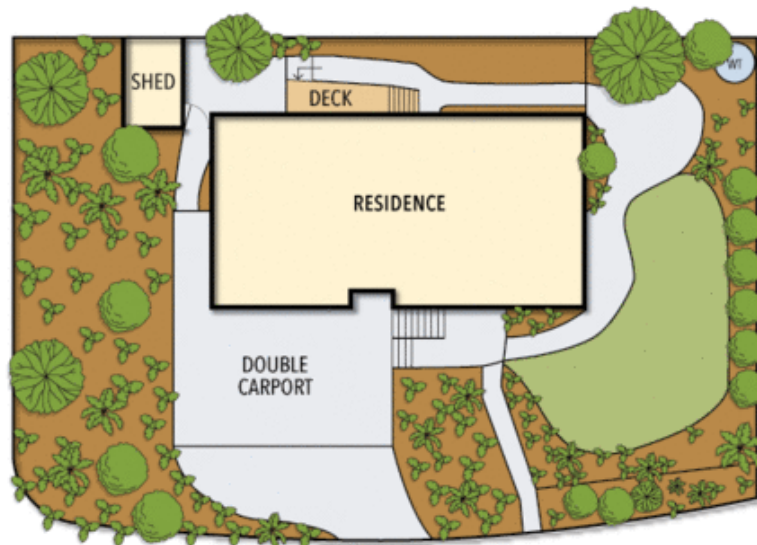

THE ABOVE PLAN IS AN ARTIST'S IMPRESSION ONLY, IT INCLUDES ELEMENTS THAT ARE FOR DISPLAY PURPOSES ONLY AND MAY NOT BE TO SCALE. LANDSCAPING SHOWN IS INDICATIVE ONLY. DIMENSIONS ARE APPROXIMATE.